

ADSL Transformer

SPECIFICATIONS :

ELECTRICAL :

D.C. RESISTANCE : 1-4 = 0.37 OHMS \pm 10% @ 20°C

2-5 = 0.37 OHMS \pm 10% @ 20°C

10-7 = 0.47 OHMS \pm 10% @ 20°C

9-6 = 0.47 OHMS \pm 10% @ 20°C

INDUCTANCE : 1.27mH \pm 7%, 10KHz, 50mVAC, 1-5 (TIE 2+4), Ls

LEAKAGE INDUCTANCE : 5.0 μ H MAX. 100KHz, 50mVAC, 1-5 (TIE 2+4, 7+9, 6+10), Ls

TURNS RATIO : (2-5) : (1-4) = 1 : 1, \pm 1%

(10-6) : (1-5) = 1 : 1, (TIE 2+4, 9+7) \pm 1%

DIELECTRIC RATING : 1000 VAC, 1 MINUTE TESTED BY APPLYING 1250VAC FOR 1 SEC.

BETWEEN 1-10, 1-9, 2-10, 2-9

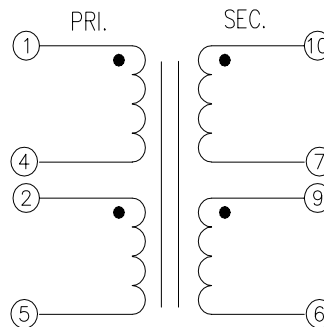
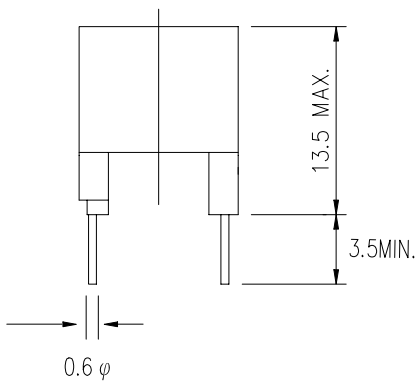

SCHEMATIC

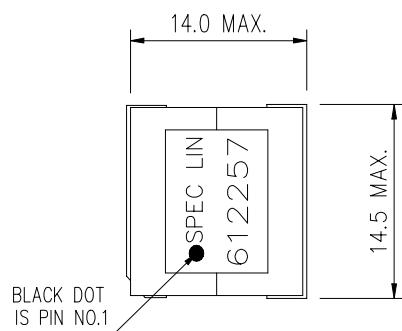

TOP VIEW

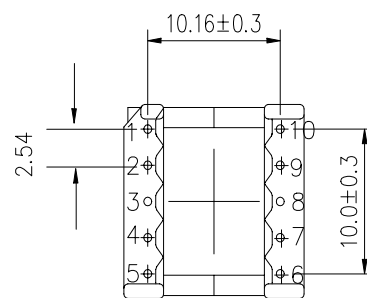

BOTTOM VIEW

CHECKUP : _____

DESIGN : _____

DRAWER : _____

SPEC LIN ENTERPRISE CO. LTD.

2F, No. 6, ALLEY 17, LANE 42, CHUNG HSING N. ST.

SAN CHUNG CITY, TAIPEI, TAIWAN

TEL: 886-2-29991394 FAX: 886-2-22781629

AGENCY NO.

UL NO. : E181559

CSA NO. : LR107869

ISO 9002: 036809750

DRAWING NO. 612257

MIDCOM NO : 50623

UNITS

mm

SHEET

1 OF 1

