

ISDN Pulse Transformer

SPECIFICATIONS :

ELECTRICAL :

D.C. RESISTANCE : 2-4 = 3.2 OHMS MAX. @ 20°C @ 1KHz, 1Vrms

10-6 = 6.0 OHMS MAX.

TURN RATIO : (2-4) : (10-6) = 1 : 1.8 ± 2% @ 15.75KHz, 1Vrms

D.C. CURRENT : 150 mA MAX. IN PRI.

INDUCTANCE (2-4) : 0.9 m H ± 10% @ 10KHz, 0.1Vrms

LEAKAGE INDUCTANCE (10-6) : 50 μH MAX. @ 100KHz, 0.1Vrms (TIE 2+4)

INTERWINDING CAPACITANCE (2-10) : 70 pF MAX. @ 10KHz, 1Vrms (TIE 2+3+4+6+7+9+10)

RETURN LOSS : 18 dB MIN. @ 40KHz - 200KHz,

SEC. WITH 41.6 OHMS LOAD, REF 135 OMHS ON PRI.

TOTAL HARMONIC DISTORTION : -70 dB MAX. @ 5KHz, 6.2dBm, 135 OMHS

LONGITUDINAL BALANCE : 50 dB MAX. @ 5KHz - 196KHz

HI-POT TEST : 1.50 KVAC MIN. BETWEEN PRI. & SEC. 1mA FOR 2 SECONDS

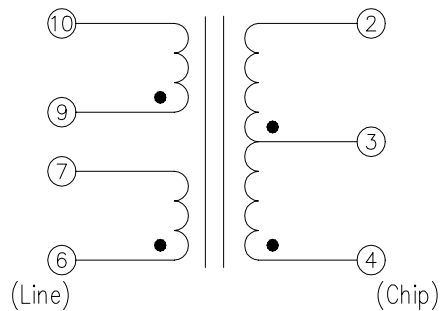
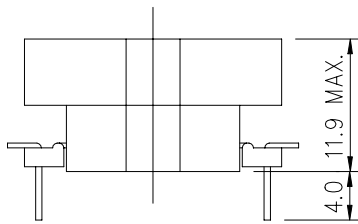

SCHEMATIC

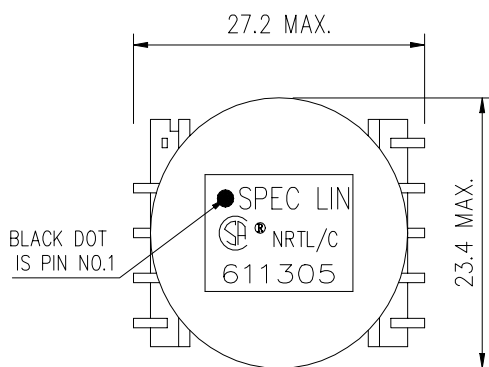

TOP VIEW

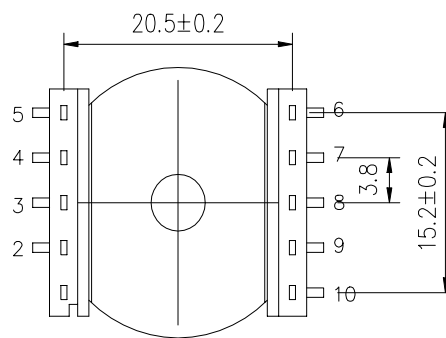

BOTTOM VIEW

SPEC LIN ENTERPRISE CO. LTD.

2F, No. 6, ALLEY 17, LANE 42, CHUNG HSING N.S.T.
SAN CHUNG CITY, TAIPEI, TAIWAN
TEL: 886-2-29991394 FAX: 886-2-22781629

AGENCY NO.

UL NO. : E181559

CSA NO. : LR107869

ISO 9002 : 036809750

DRAWING NO.

611305

UNITS
mm

SHEET
1 OF 1

